

**EATON COUNTY ROAD COMMISSION
CHARLOTTE, MICHIGAN**

**PROPOSAL FOR
2023 TRAFFIC CONTROL**

**To: Board of Eaton County Road Commissioners
1112 Reynolds Road
Charlotte, Michigan 48813**

The undersigned has examined the Plans, Specifications, and the Location of the work described herein and is fully informed as to the nature of the work and the conditions relating to its performance. The undersigned also understands that the quantities shown are approximate only and are subject to either Increase or Decrease on individual locations, and that additional project locations may be added throughout the county during the construction season.

The undersigned hereby proposes to furnish all necessary equipment, tools, apparatus, and other means of construction; do all the work and furnish all the materials; and, for the unit prices named in the itemized bid, complete the work herein described, in strict accordance with the plans thereof, and in strict conformity with the requirements of the 2020 Michigan Department of Transportation Standard Specifications for Construction and such other special provisions and supplemental specifications included as part of this proposal.

The undersigned further proposes to do such extra work as may be authorized by the Eaton County Road Commission, prices for which are not included in the itemized bid. Compensation shall be made on the basis agreed upon prior to commencing with extra work.

If the undersigned is the successful bidder and fails to enter into a contract and furnish satisfactory bonds to the Eaton County Road Commission within 15 days after being furnished with the necessary contract and bond forms, the road commission will award the project to the next low bidder.

Company Name _____

Address _____

Phone # _____

Fax # _____

E-Mail _____

Signed by _____

Date _____

EATON COUNTY ROAD COMMISSION

2023 CONSTRUCTION PROJECT TRAFFIC CONTROL

04/26/2023

BID BLANK

BID ITEM	QUANTITY	UNIT	UNIT PRICE	TOTAL AMOUNT
		Square		
Sign, Type A, Temp, Prismatic	497	Foot	\$ _____	\$ _____
Barricade, Type III, High Intensity, Double Sided	17	Each	\$ _____	\$ _____
		Totals =	\$ _____	\$ _____

The undersigned agrees that the quantities provided on the Contract A Bid Blank are estimates. Actual quantities paid will be based on final field measurements. The Eaton County Road Commission reserves the right to increase or decrease quantities, or add or eliminate entire projects from the contract. No unit price changes will be allowed as a result of increased or decreased quantities, or for added or eliminated projects.

Company Name _____

Date _____

Address _____

Phone # _____

Fax # _____

Signed by _____

EATON COUNTY ROAD COMMISSION

2023 Construction Project Traffic Control

04/26/2023

Item Quantities

Project Location	Sign Number	MMUTCD Code	Length	Width	Area (Each)	Total Number	Area (Total)	
			inch	inch	sft	each	sft	
Project Location 1 - Saubee Rd	1	W20-1	48	48	16.00	6	96.00	
	3	W20-3	48	48	16.00	2	32.00	
	Type III						4	128.00
Project Locations 2- Benton Rd	1	W20-1	48	48	16.00	6	96.00	
	3	R11-4	60	30	12.50	2	25.00	
	Type III						4	121.00
Project Location3 - Gunnell Rd	1	W20-1	48	48	16.00	4	64.00	
	3	R11-4	60	30	12.50	2	25.00	
	4	R11-3A	60	30	12.50	1	12.50	
Type III						4	101.50	
Project Location 6 - Waverly Rd	1	W20-1	48	48	16.00	6	96.00	
	3	R11-4	60	30	12.50	3	37.50	
	4	R11-3A	60	30	12.50	1	12.50	
Type III						5	146.00	
						Total	17	496.50

EATON COUNTY ROAD COMMISSION

2023 HMA BASE CRUSHING AND SHAPING PROJECT LOCATIONS

PROJECT LOCATIONS

01/24/23 MMH

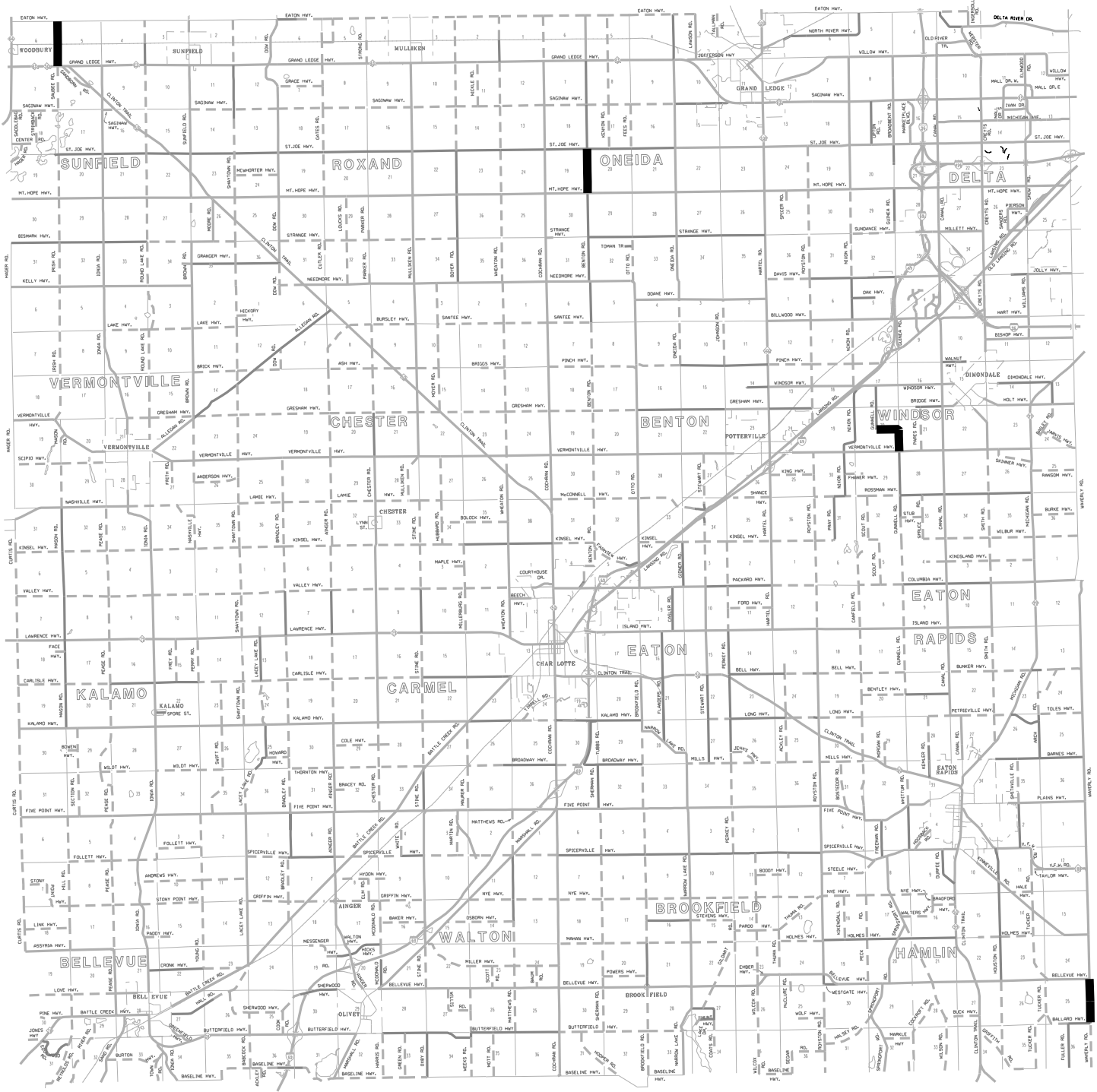

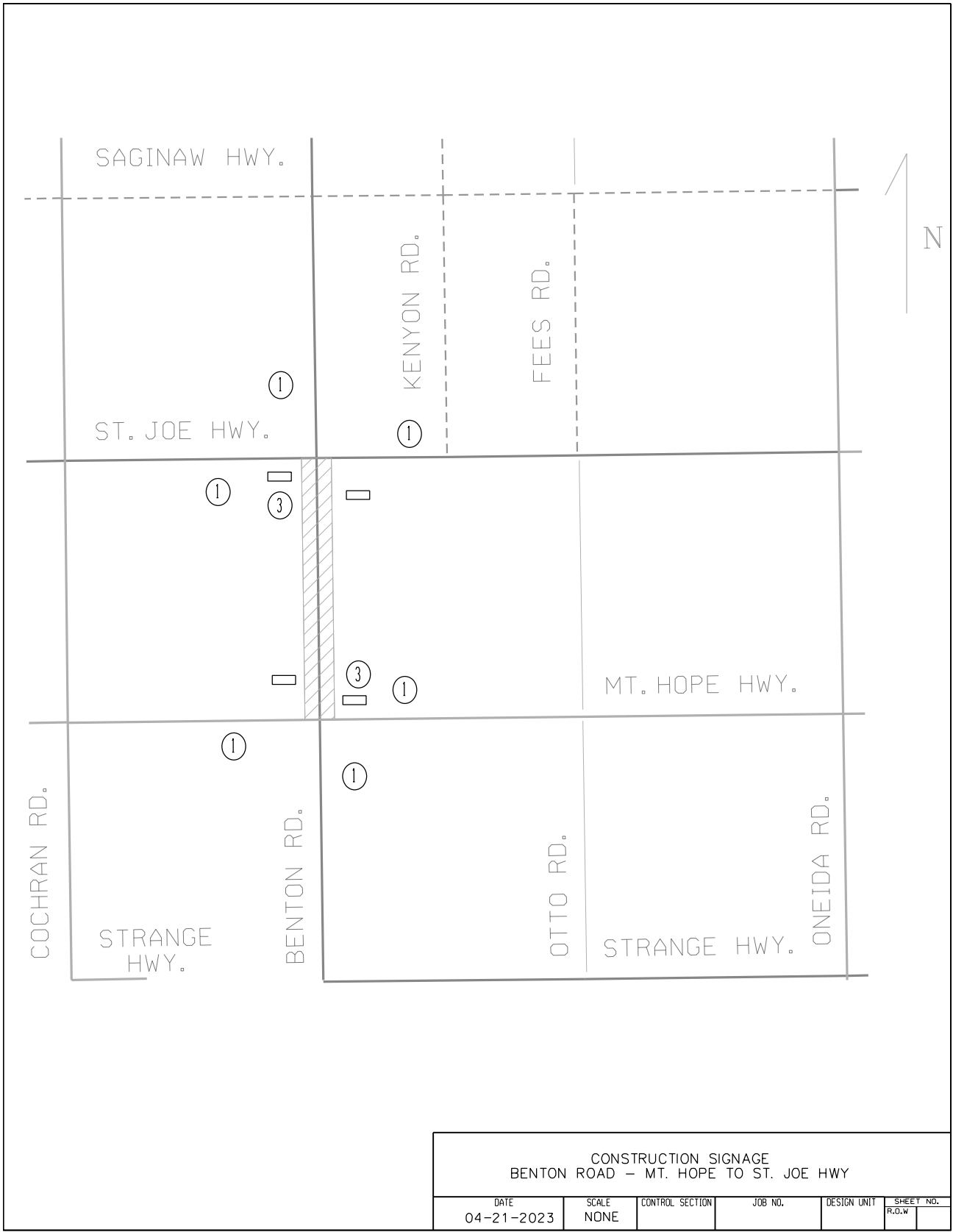

CONSTRUCTION SIGNAGE
 BENTON ROAD - MT. HOPE TO ST. JOE HWY

DATE	SCALE	CONTROL SECTION	JOB NO.	DESIGN UNIT	SHEET NO.
04-21-2023	NONE				R.O.W

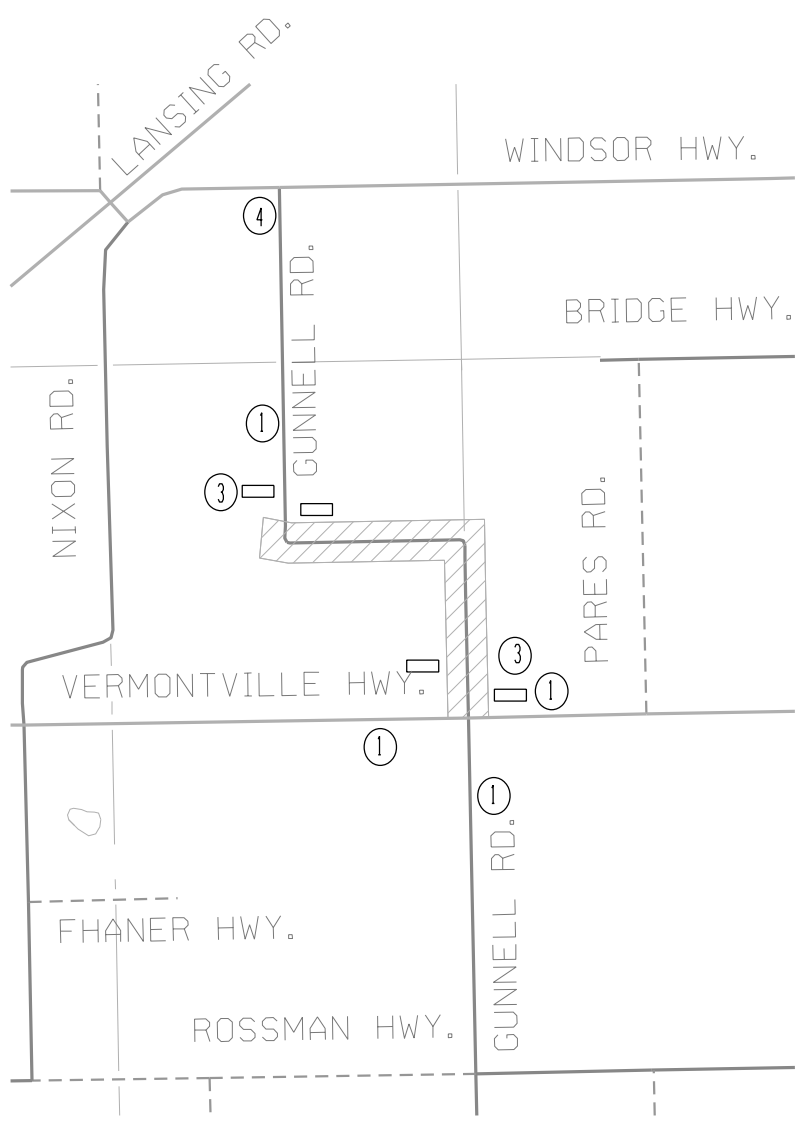

CONSTRUCTION SIGNAGE GUNNELL ROAD - VERMONTVILLE HWY. TO 1 MILE NORTH				
DATE 04-24-2023	SCALE NONE	CONTROL SECTION	JOB NO.	DESIGN UNIT
				SHEET NO. R.O.W

SIGN LEGEND

①

W20-1 48 X 48

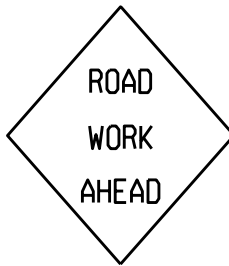

②

W20-3 48 X 48



③

R11-4 60 X 30

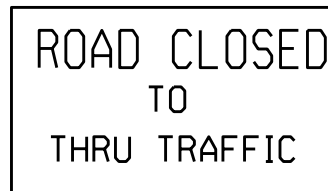

④

R11-3A 60 X 30

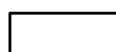
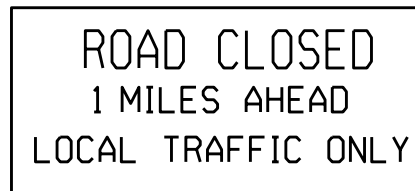

TYPE III LIGHTED BARRICADE

CONSTRUCTION SIGNAGE
 SAUBEE RD, BENTON RD, GUNNELL RD,
 COCHRAN RD, AND WAVERLY RD.

DATE	SCALE	CONTROL SECTION	JOB NO.	DESIGN UNIT	SHEET NO.
04-21-2023	NONE				R.O.W

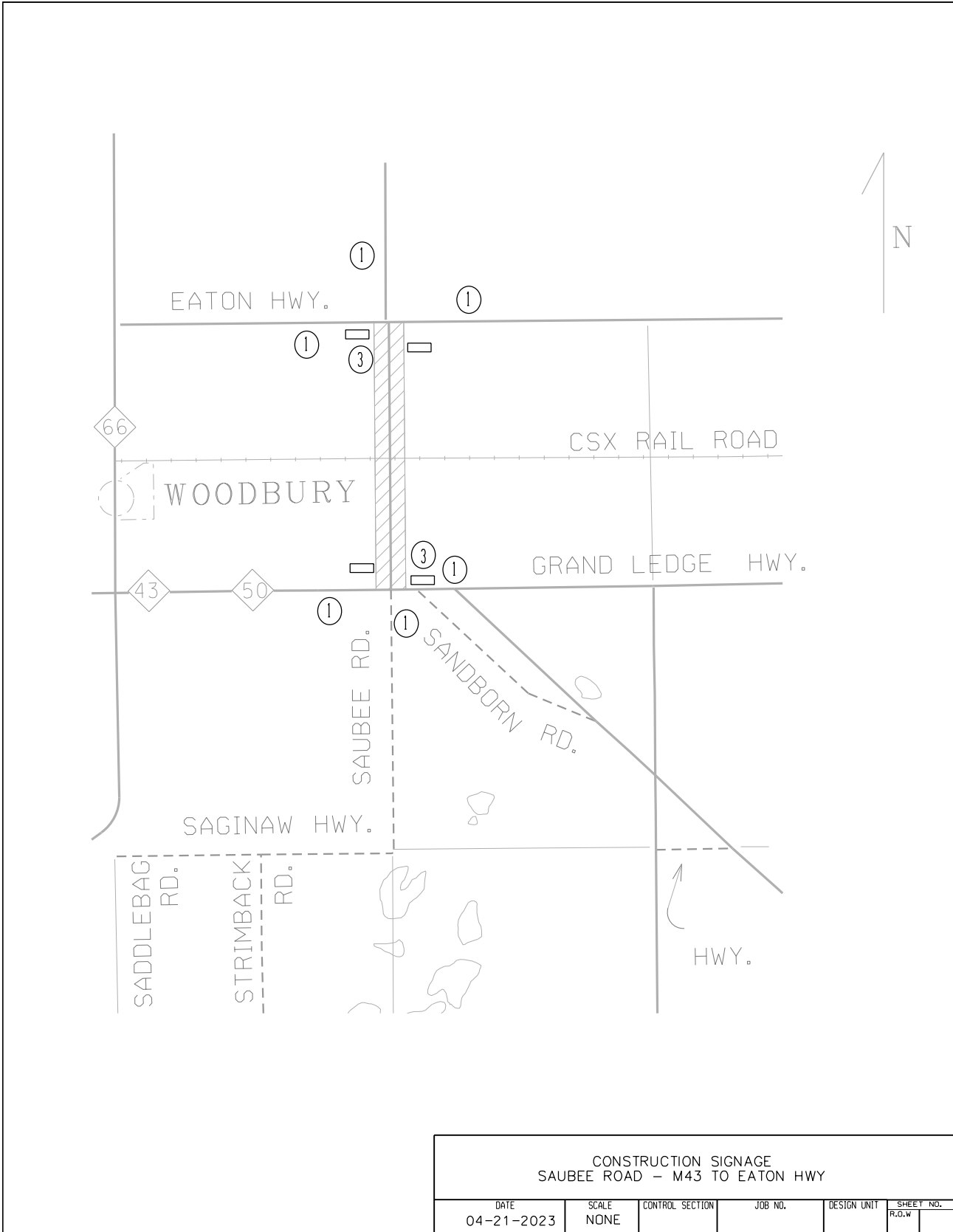

CONSTRUCTION SIGNAGE
 SAUBEE ROAD - M43 TO EATON HWY

DATE	SCALE	CONTROL SECTION	JOB NO.	DESIGN UNIT	SHEET NO.
04-21-2023	NONE				R.O.W

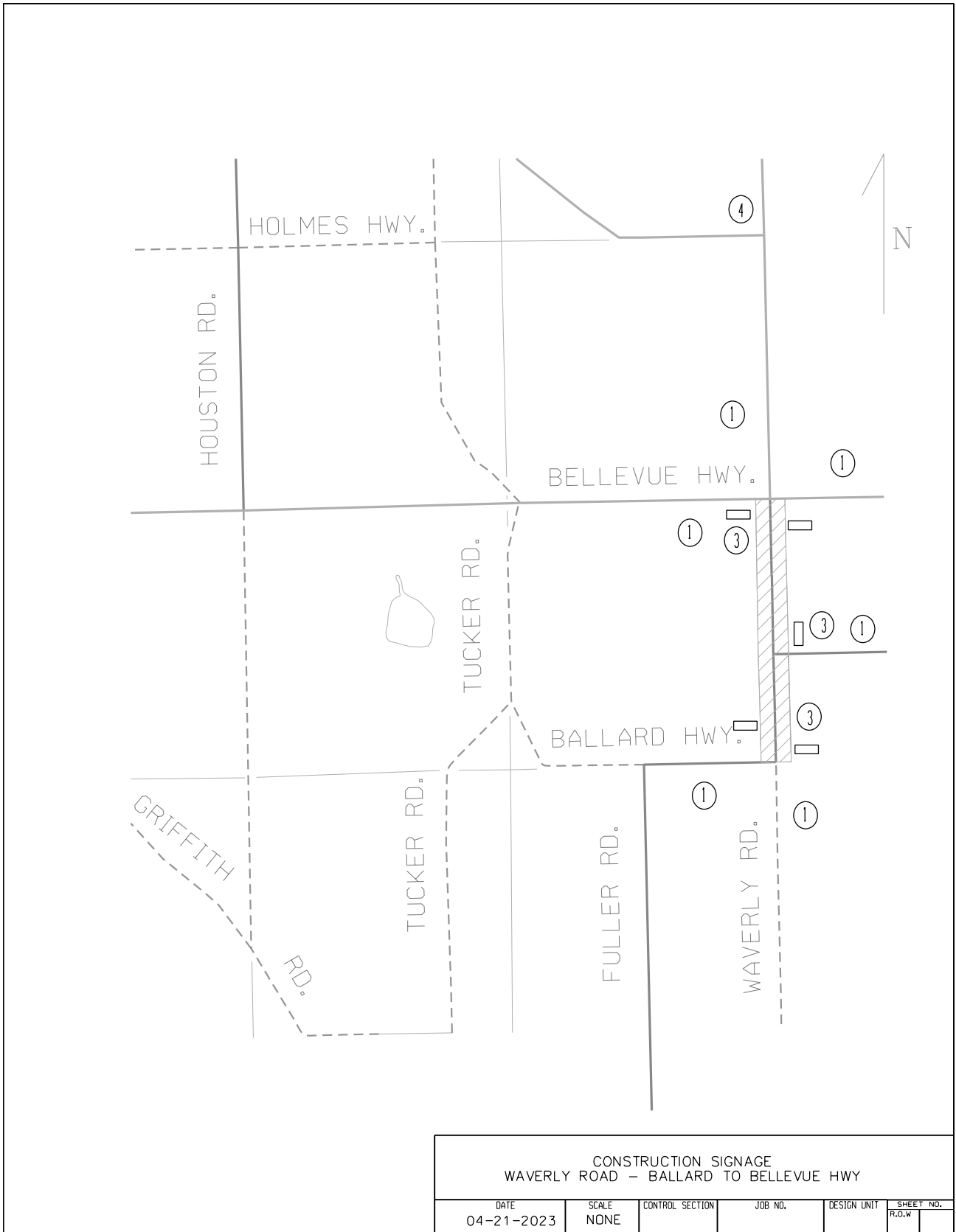

CONSTRUCTION SIGNAGE
 WAVERLY ROAD - BALLARD TO BELLEVUE HWY

DATE	SCALE	CONTROL SECTION	JOB NO.	DESIGN UNIT	SHEET NO.
04-21-2023	NONE				R.O.W

EATON COUNTY ROAD COMMISSION

SPECIAL PROVISION
FOR
MAINTAINING TRAFFIC

ECRC

1 of 1

04/21/22

a. Description. This special provision consists of requirements and restrictions to maintain traffic on all crush and shape jobs in Eaton County.

b. General. Traffic control shall be provided for the duration of the project as indicated on the project maps in accordance with Sections 104.11 and 812 of the 2020 Michigan Department of Transportation Standard Specifications for Construction, the Special Provisions, and as specified herein. Signs must meet MMUTCD specifications.

c. Traffic General. Project location maps with specified signs and locations are provided within this bid package. All signs, warning lights, barricades and all other traffic control devices, methods, and procedures shall be in accordance with the 2020 Michigan Department of Transportation Standard Specifications for Construction, the 2011 revision of the Michigan Manual of Uniform Traffic Control Devices (MMUTCD), and as specified herein. The contractor is responsible for staking sign locations before signs are post driven.

All temporary sign supports for detour and traffic control **shall be driven** per MDOT Standard Plan WZD-100-A and the 2020 Standard Specifications for Construction before any construction is permitted to start.

d. Schedule. Work is expected to begin in mid-May and be completed by the end of August. Projects completed prior to the end of August shall have the signs removed when directed by the Engineer. Signs shall remain for projects that are not complete and open to traffic by the end of August. The Contractor should expect all projects to be closed concurrently

e. Measurement and Payment. Items used for this project will be measured and paid for in accordance with the 2020 Michigan Department of Transportation Standard Specifications for Construction, except the **Oper** and **Furn** items will not be measured separately. Payment for the item will include all work, materials, equipment, and labor included in both the **Furnished** and **Operated** items as specified in the standard specifications.

Traffic control devices will be measured separately at each project location. Unit price payment for all traffic control items delivered and installed on these projects will be payment in full. Minor Traffic Devices is not a pay item on this project.

No payment will be made for devices damaged during construction.

Pay Item	Pay Unit
Sign, Type A, Temp, Prismatic	Square Foot
Barricade, Type III, High Intensity, Double Sided.....	Each